

INSTALLATION FIXTURE
HOLDS MOUNT WHILE
ADHESIVE CURES.

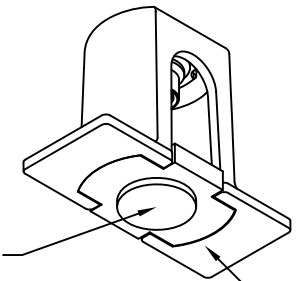

MOUNT ATTACHED BY
ADHESIVE APPLIED TO
THIS SURFACE.

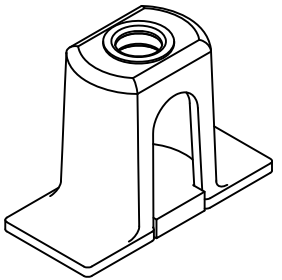

NUT AND RETAINER MATERIAL AND FINISH DATA

CODE	NUT MATERIAL	SPEC.	DRI-FILM LUBE	RETAINER MATERIAL	SPEC.	PASSIVATE
CR	A-286 CRES	AMS 5525	AS5272	A-286, 304, 305 CRES	AMS 5525, 5639, 5514	AMS 2700

BASEPLATE MATERIAL

CODE	MATERIAL
U	GLASS/PEI, 30% GLASS
UC	CARBON/PEI, 30% CARBON
V	GLASS/PEI, 40% GLASS
VC	CARBON/PEI, 40% CARBON

LENGTH L DATA

CODE	L
12	.750
16	1.000
24	1.500
32	2.000

THREAD DATA AND RECOMMENDED SCREW TIGHTENING TORQUE

CODE	THREAD SIZE	SPEC.	INSTALLATION TORQUE (IN-LBS)
08	.1640-32 UNJC-3B	AS8879	15-20
3	.1900-32 UNJF-3B		25-35
4M	MJ4 X 0,7 4H6H	ISO 5855	15-20
5M	MJ5 X 0,8 4H6H		25-35

OPTIONAL BASEPLATE PRIMER

CODE	MATERIAL SPEC.
P	MIL-PRF-85582

RADIAL FLOAT OF NUT .030 MIN FROM CENTER.
SCREW CAN ENGAGE MAX MISALIGNED NUT.
THREAD LOCK BY ELLIPTICAL DEFORMATION.

STRENGTH REQUIREMENT: WILL WITHSTAND
A 50 LB LOAD APPLIED IN ANY DIRECTION.

EXAMPLE PART NUMBER

CB4523 V 3 CR 16 P

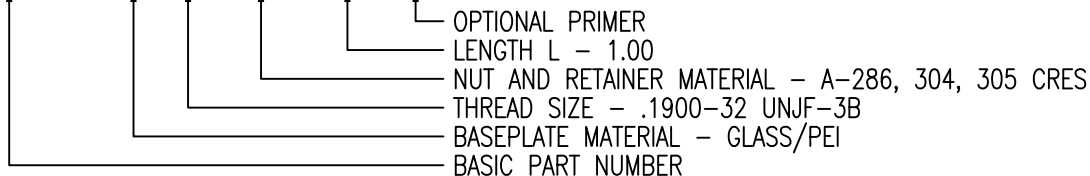

UNLESS OTHERWISE SPECIFIED, ALL DIMENSIONS ARE IN INCHES AND TOLERANCES ARE AS SHOWN BELOW. DIMENSIONAL TOLERANCES AND SYMBOLS PER ANSI Y14.5M-1982.

PROPRIETARY PARTS SHOWN IN THIS DRAWING ARE THE SUBJECT OF ISSUED UNITED STATES AND FOREIGN PATENTS AND PATENTS PENDING. UNAUTHORIZED REPRODUCTION AND/OR DISTRIBUTION OF THIS DRAWING IS SPECIFICALLY PROHIBITED.

CLICK BOND

CARSON CITY
NEVADA 89706

APPROVALS		DATE	TITLE				
ANGLES	±1°	DRAWN BPEREZ	8JUL13	NUTPLATE, STANDOFF, COMPOSITE, INTERNALLY FIXTURED			
.XX	±.03	CHECKED BPEREZ	21JUL17	SIZE	CAGE CODE	DWG. NO.	REV.
.XXX	±.010	RELEASED ADAL	01AUG17	A	66530	CB4523	1
.XXXX	±.001	REVISED BPEREZ	21JUL17	SCALE	1/1	21JUL17	SHEET 1 OF 1